

SoundMat 3 Plus 15mm

1.2m x 1m x 15mm (1.2m²)

Weight 19kg Per mat

Technical Information Sheet



SoundMat 3 Plus 15mm offers a high performance floor noise barrier, reducing both impact and airborne sound. SoundMat 3 Plus 15mm is primarily designed for timber floors although can also be used with concrete floor constructions. SoundMat 3 Plus 15mm provides high quality sound insulation; therefore it is ideal for developments where superior noise control is necessary. The high performance composite is a sandwich of two layers of 7.5kg acoustic barrier separated by a 10mm layer of SoundMat acoustic foam. The SoundMat foam offers greater resistance to compression and creep allowing greater loads to be applied.

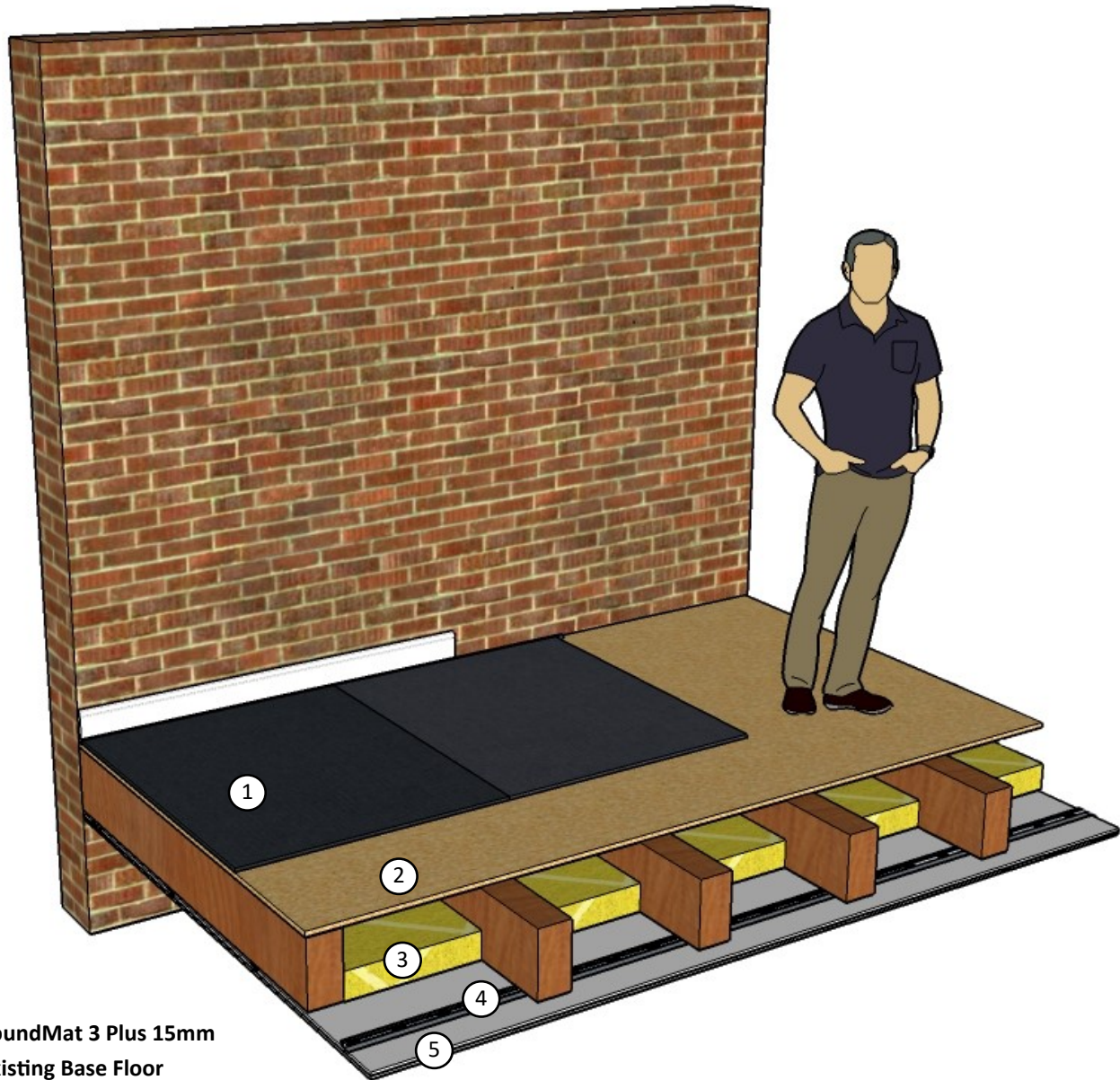

- 1: SoundMat 3 Plus 15mm
- 2: Existing Base Floor
- 3: 100mm Acoustic Mineral Wool
- 4: Resilient Bar
- 5: Double Layer of 15mm Acoustic Plasterboard

Performance

Airborne: 54dB
Impact: 49dB

SoundMat 3 Plus 15mm

SoundMat 3 Plus 15mm acoustic foam and 7.5kg Barrier are high performance materials that have been acoustically tested at a WAS certified independent acoustic test laboratory from which the following data has been compiled.

Example Build Up 1

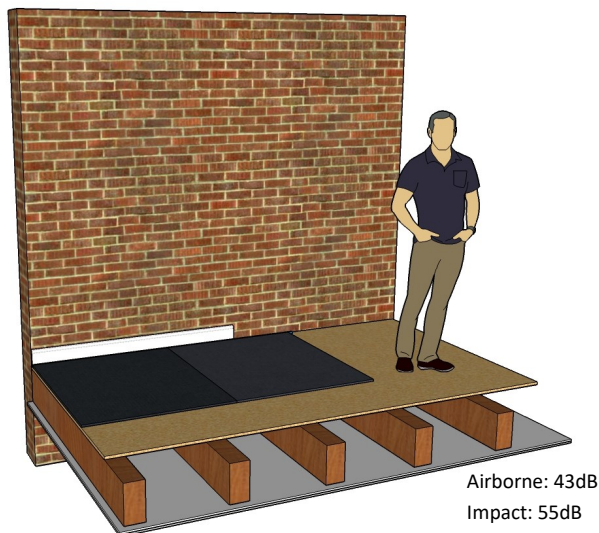

Example Build Up 2

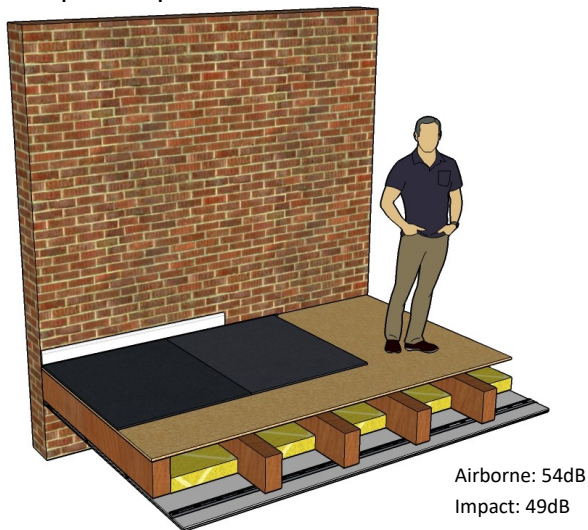

Building Regulations Part E (UK) Requirements	Impact Performance	Airborne Performance
Purpose built dwelling or flats:		
Floors and Stairs	(less than) 62dB	(higher than) 45dB
Dwellings-houses or flats formed by change of use:		
Floors and Stairs	(less than) 64dB	(higher than) 43dB

SoundMat 3 Plus15mm Specifications:		
Size: 1200mm x 1000mm x 15mm (1.2m2)	Weight: 19kg per sheet	Max 50 sheets per pallet
Acoustic performance on a timber joisted floor	Impact Performance (The lower the figure the better)	Airborne Performance (The higher the figure the better)
Example Build Up 1		
With two layers of acoustic plasterboard or lath and plaster ceiling below (No Mineral Wool) (Boarder line pass for building regulations)	55dB	43dB
Example Build Up 2		
With resilient bars & two layers of acoustic plasterboard on the ceiling below, and 100mm 60kg Rockwool between joists. (Passes building regulations)	49dB	54dB

Benefits of SoundMat 3 Plus 15mm

- Reduces impact sound
- Improves airborne sound performance
- Suitable for use with concrete and timber floating floors
- Flexible, easily cut and simple install
- Supplied in thin, easy to handle tiles
- Closed cell moisture resistant foam
- Cost effective
- Simple to install
- Suitable for all final floor finishes
- Can withstand heavier loads being applied

Accessory's SoundMat 3 Plus 15mm

- Acoustic Sealant
- High Tack Tape
- Carpet Gripper Strip
- Impacta Adhesive

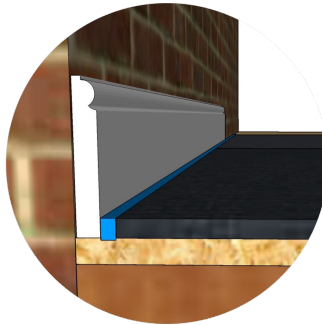

Acoustic Sealant

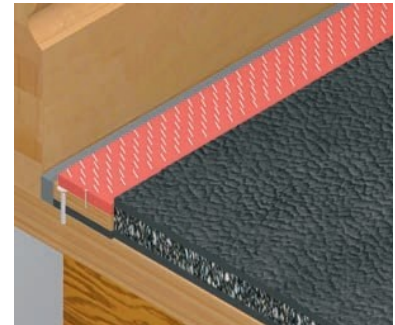

Carpet Gripper Rods

WB acoustic barrier material is a high-density mineral loaded thermoplastic polymer. It is black in colour, ecologically neutral and recyclable.

SoundLay foam is an acoustic underlay manufactured from EVA rubber injected closed cell polyolefin foam.

INSTALLATION

SoundMat 3 Plus 15mm is supplied in standard sheet/tile sizes. These are easy to lay on the floor in a staggered pattern, placing tightly together.

SoundMat 3 Plus 15mm sheets can be laid loose or bonded to the floor. When bonding to the floor, ensure that the surface is clean, dry, grease free and that the flooring is secured before bonding. Floor Adhesive should be used. The SoundMat 3 Plus 15mm sheets can be pushed up to the skirting board or wall; ensuring a tight fit to prevent flanking of airborne noise. When loose laid the joints should be taped using High Tack Tape to prevent movement.

COMPATIBLE FLOOR FINISHES

Carpets – Can be installed using grippers or by bonding. Contact 123 Soundproofing for advice on the selection and fitting of grippers. When bonding carpet, it is recommended that SoundMat 3 Plus 15mm sheets are first bonded to the floor, using Floor Adhesive.

Laminate – Where a wooden laminated floor finish is being used, it is recommended that a layer of 6mm T+G plywood is bonded to the SoundMat 3 Plus 15mm first, using Floor Adhesive.

Vinyl – Where vinyl floor coverings are to be used, it is recommended that a layer of 6mm T+G plywood is to be bonded to the SoundMat 3 Plus 15mm first, using Floor Adhesive.

Engineered Wood— Where engineered wood flooring covering are to be used. If the new wood flooring is 18mm or thicker this can be used directly on top of the SoundMat 3 Plus and should be bonded using Floor Adhesive. For thinner than 18mm we recommended that a layer of 6mm T+G plywood is to be bonded to the SoundMat 3 Plus15 first, using Floor Adhesive.

Tiles—Where Tiles coverings are to be used. We recommend a minim of 12mm T&G plywood is bonded to the SoundMat 3 Plus15 first, using Floor Adhesive.

Please note: For installations and applications not listed, please contact Soundproofing Store for guidance.

Recommended Adhesive – For bonding to the subfloor, Floor Impacta Adhesive, which should be applied by brush or by roller. For further guidance please contact Soundproofing Store.